

FLOOR PLAN

DIMENSIONS

Entrance Hall

Lounge Diner
21'7" x 11'5" (6.60 x 3.48)

Kitchen
11'7" x 10'0 (3.53m x 3.05m)

Downstairs Cloakroom
6'2" x 3'2 (1.88m x 0.97m)

Landing

Bedroom One
10'7" x 9'4 (3.23m x 2.84m)

En Suite
8'8" x 10'7 (2.64m x 3.23m)

Bedroom Two
11'5" x 7'3 (3.48m x 2.21m)

Bedroom Three
10'2" x 7'5 (3.10m x 2.26m)

Bathroom
6'7" x 7'6 (2.01m x 2.29m)

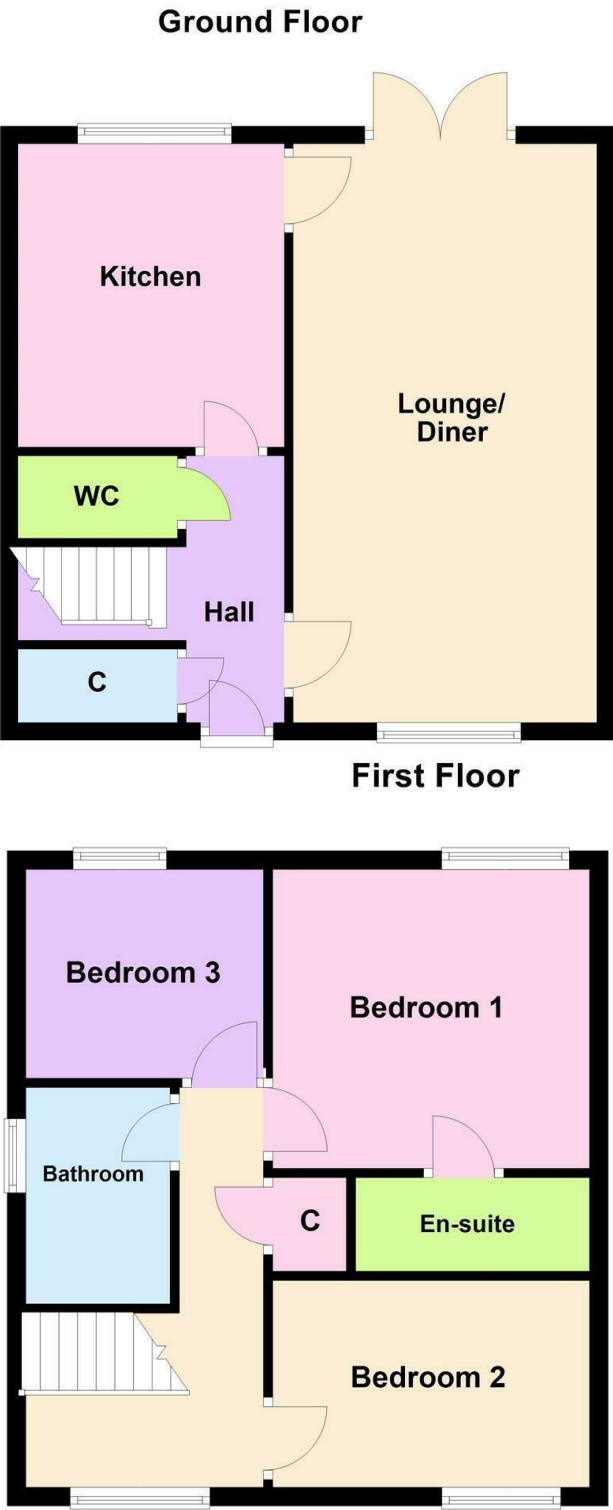

OVERVIEW

- Stunning Family Home
- Popular Location
- Entrance Hall
- Spacious Lounge Diner
- Modern Kitchen & Downstairs Cloakroom
- Three Bedrooms
- En Suite To Primary & Family Bathroom
- Driveway, Garage & Garden
- Viewing Is Essential
- Freehold, EER - C, Tax Band - D

LOCATION LOCATION....

Enderby has everything to offer as a thriving village which is located south west of the city. Enderby offers an excellent range of amenities local shops which cater for day to day living, a leisure centre and a nine hole golf course, fashionable restaurants, pubs, Enderby Danemill Primary School, Brockington College for the older children and all within easy access to the city centre with the Park and ride, motorway networks and Fosse Park Shopping Centre.

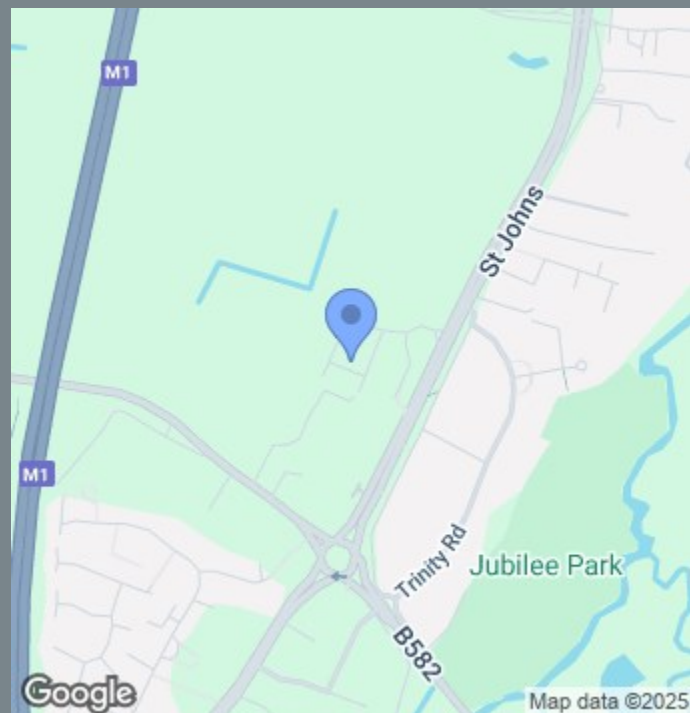

THE INSIDE STORY

Discover this stunning detached home nestled in a modern development, offering a perfect blend of contemporary design and comfort. Situated in a lovely location, this property boasts no onward chain, making it an ideal choice for those looking for a seamless move. Step into the welcoming entrance hall, setting the tone for the rest of the home with its bright and airy ambiance. The spacious lounge diner is perfect for both relaxation and entertaining, featuring a window to the front that allows natural light to flood in, while French doors open up to the garden, creating a seamless indoor-outdoor living experience. The heart of the home, the modern fitted kitchen, is equipped with stylish shaker units, a sink drainer with mixer tap, plumbing for a washing machine and space for a fridge freezer. It also offers space for a table and chairs, making it ideal for breakfast or a morning coffee. Conveniently located on the ground floor, the downstairs cloakroom adds practicality to the layout. The landing provides access to the upper level, where you'll find the bedrooms and bathrooms. This home offers three well-appointed bedrooms, with the primary bedroom featuring fitted wardrobes and an en suite shower room, providing a private retreat. The family bathroom is designed with modern fixtures and fittings, catering to the needs of the entire household. The property includes a driveway and a garage, ensuring ample parking and storage space. The garden, complete with a patio and lawn, is perfect for outdoor enjoyment and relaxation. This beautiful detached home in a modern development is a true gem, offering a perfect combination of style, comfort, and convenience. Don't miss the opportunity to make it your own!

